



FOR LEASE

CLASS "A" OFFICE SPACE

*2500 York Road
Jamison, Bucks County, PA*

COMMERCIAL • INDUSTRIAL • INVESTMENT

High Visibility Location



PROPERTY FEATURES

- Office suites available on the first floor
 - Suite 110 - 5,298 Sq. Ft. (divisible to 1,442 SF)
 - Suite 115 - 964 Sq. Ft.
 - Suite 100 - 349q. Ft.
- Dramatic 2 story lobby atrium with balcony
- Daily janitorial services included
- Building access security system
- Excellent parking ratio
- Abundant natural light - Floor to ceiling window lines
- Auxiliary power for data communications
- Signalized intersection
- Floor plans can be modified to suit
- \$24.00 PSF plus utilities

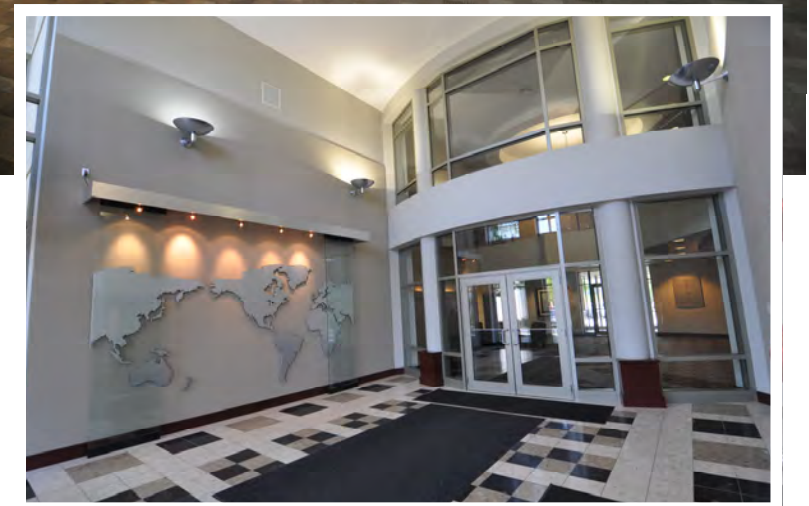

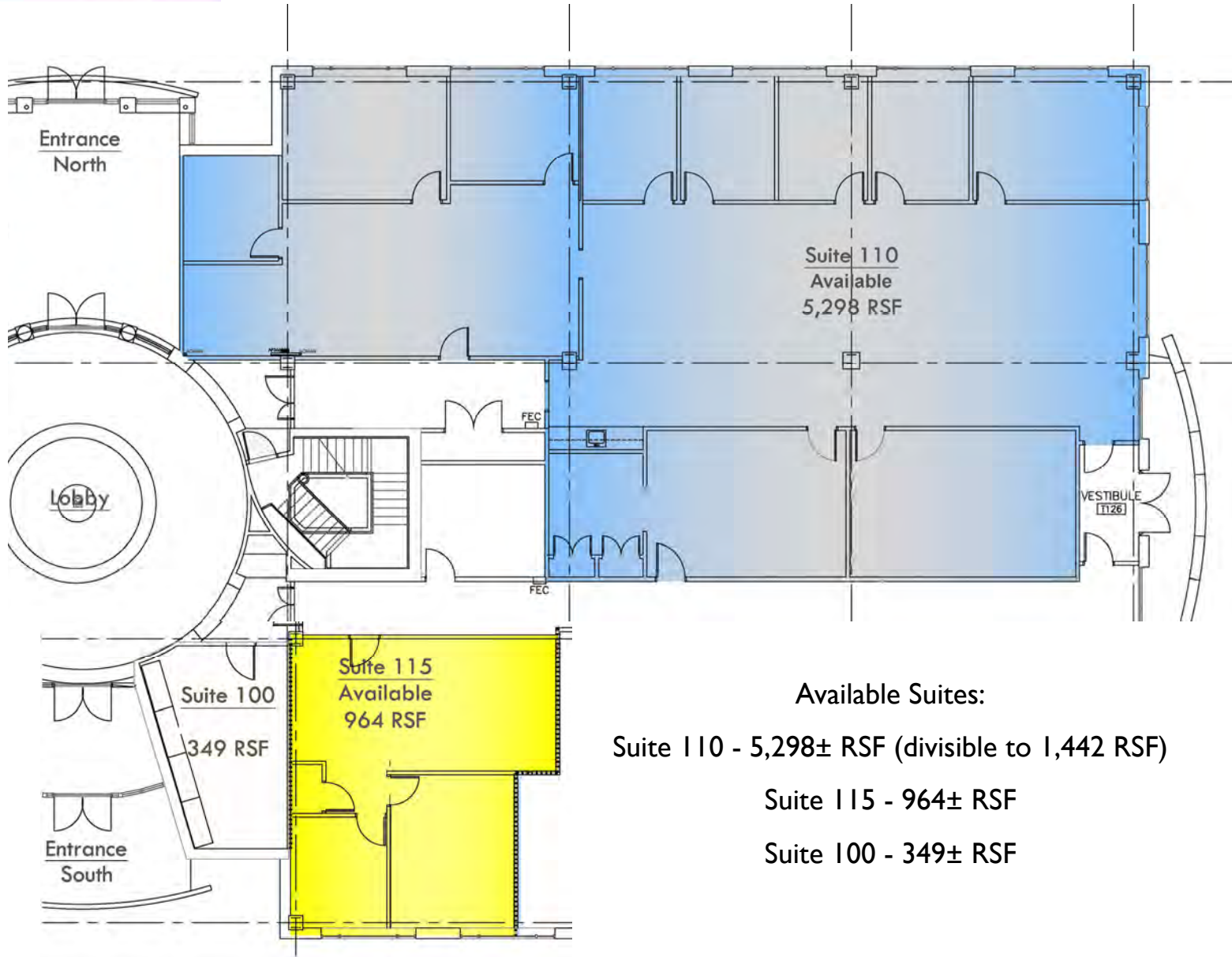

Available Suites:

Suite 110 - 5,298± RSF (divisible to 1,442 RSF)

Suite 115 - 964± RSF

Suite 100 - 349± RSF



Suite 115 - 964± RSF





Suite 110 - 5,298± RSF (Tenant chooses carpeting)

